

# EZ-PLUG PATCH

## Overview

The Quarrix EZ-PLUG Patch makes it easy to cover pre-existing holes on the roof. Using sheet metal to patch holes in the roof deck can create a place for condensation to drip into the attic and may void your shingle warranty. Try a better way with the Quarrix EZ-PLUG Patch. The patch installs easily with nails and resists cracking and weakening in all temperature extremes. Available in 8" and 12" sizes.



## Quarrix EZ-PLUG Patch Benefits

- Proven Performance**  
 Holds up to 600 lbs without contracting or expanding in extreme weather.
- Efficient Installation**  
 Installs 12 times faster than plywood or metal patches saving time and money.
- System Solution**  
 Easily patches holes left by pot vents, turtlebacks, or whirlybirds for easy conversion to ridge ventilation.
- Industry Standard**  
 Pairs perfectly when converting from box-style vents to Quarrix's leading ridge ventilation products or other ridge vents.



**8" EZ-PLUG Patch**  
 Designed for patching holes left by Pot and Turtle Vents. Fills holes up to 8" x 8"



**12" EZ-PLUG Patch**  
 Ideal size for filling holes left by Whirlybird/Turbine vents. Fills holes up to 12" x 12"

## Time Saving Efficient Installation!

See for yourself - scan QR Code for installation video

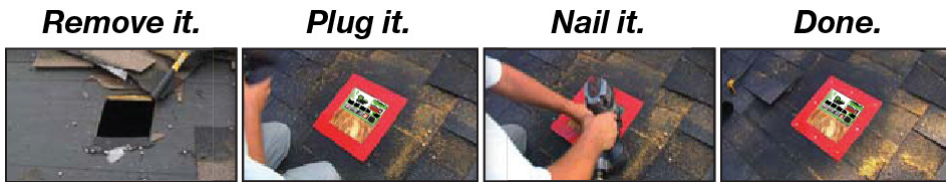

## EZ-PLUG PATCH SPECIFICATIONS

Part #	Patch Size	Outside Dimensions	Wood Dimensions	Thickness	Material	Weight Limit
97046	8" Patch	11-7/8" x 11-7/8"	7-1/2" x 7-1/2"	7/16"	ABS Plastic and 7/16" OSB Sheeting	Over 600 lbs.
98000	12" Patch	15-7/8" x 15-7/8"	11-1/2" x 11-1/2"	7/16"	ABS Plastic and 7/16" OSB Sheeting	Over 600 lbs.